

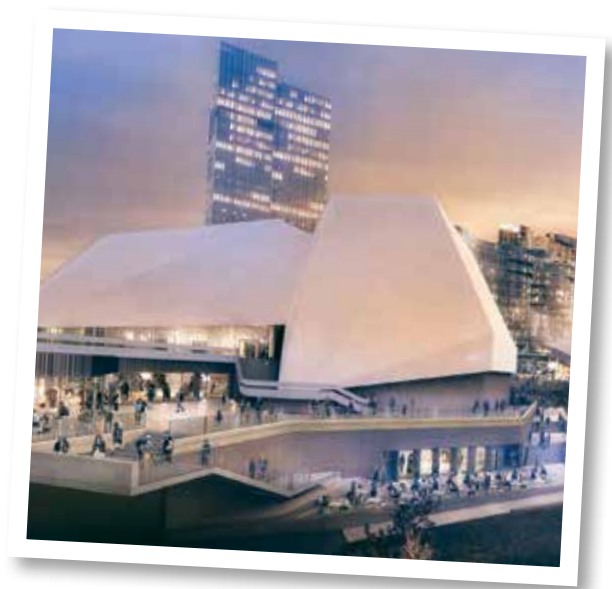

ADELAIDE'S OWN WALK OF FAME

As part of the redevelopment, Adelaide Festival Centre will create a Walk of Fame to act as an east-west promenade along the River Torrens side of the venue. This will provide pedestrian access to new entries to the Dunstan Playhouse and the Festival Theatre. In a celebration of Festival Centre's cultural heritage, the Walk of Fame will feature three artists who have performed at Festival Centre venues for each and every year since its doors first opened in 1973.



TEMPORARY CLOSURE OF FESTIVAL THEATRE

As part of the redevelopment, the Festival Theatre and its foyer will close for five months from 23 July 2017 to 26 December 2017. Other Adelaide Festival Centre venues, including Dunstan Playhouse, Space Theatre, Artspace Gallery and Her Majesty's Theatre (Grote Street) will all remain open during this period.

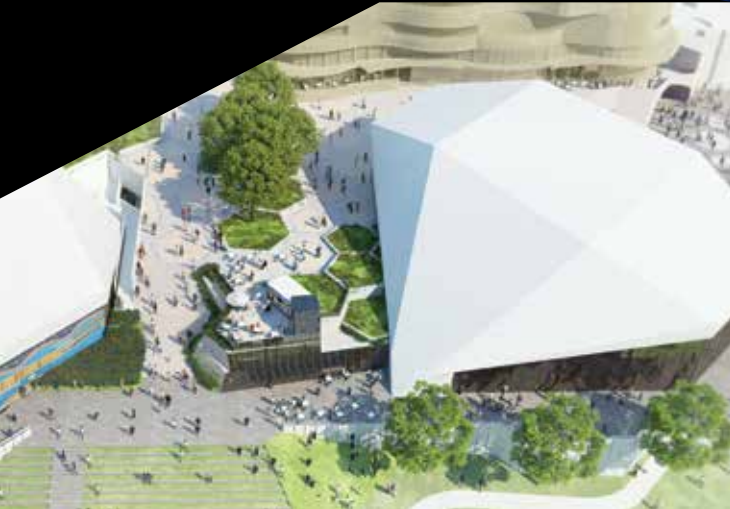



ADELAIDE FESTIVAL CENTRE REDEVELOPMENT

“Once complete, Adelaide Festival Centre will integrate seamlessly with Festival Plaza to create a lively, dynamic space buzzing with cultural and entertainment events.”



For more information:
adelaidefestivalcentre.com.au/redevelopment
renewalsa.gov.au

Contact us any time:
feedback@adelaidefestivalcentre.com.au
08 8216 8600

-  /FestivalCentre
-  @adelaidefescent
-  @AdelaideFesCent

Exciting changes are afoot at ADELAIDE FESTIVAL CENTRE!

We are part of the transformation of Adelaide Riverbank that will create a vibrant space for all South Australians and visitors to our state to come together and enjoy.

We are working on:

- Modern foyers with upgraded facilities
- New food and beverage options
- Technical equipment upgrades in the theatres
- A children's arts playground
- Adelaide's very own star-studded Walk of Fame

The current redevelopment is the most significant capital infrastructure project undertaken since our doors opened in 1973.

CAR PARKING

Adelaide Festival Centre's car park will close from **1 January 2017**.

We have partnered with Wilson Parking to offer patrons discounted parking at Wilson Adelaide Central (225 North Terrace) car park.

To access the discount, book online at book-a-bay.com.au and use the promo provided via:

- Ticket confirmation email
- Your Visit email (all patrons receive this email three days prior to their show)

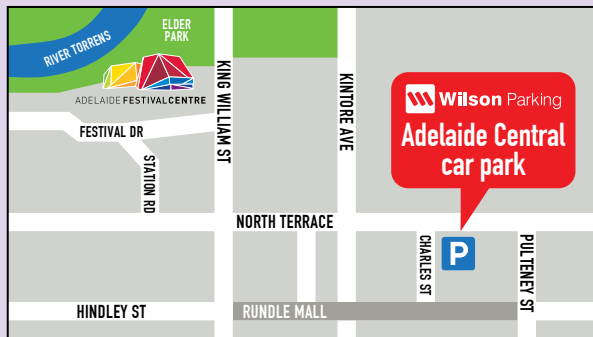

VENUE ACCESS from December 6

Ticket purchasers will receive an email with the latest access information three days prior to their performance.

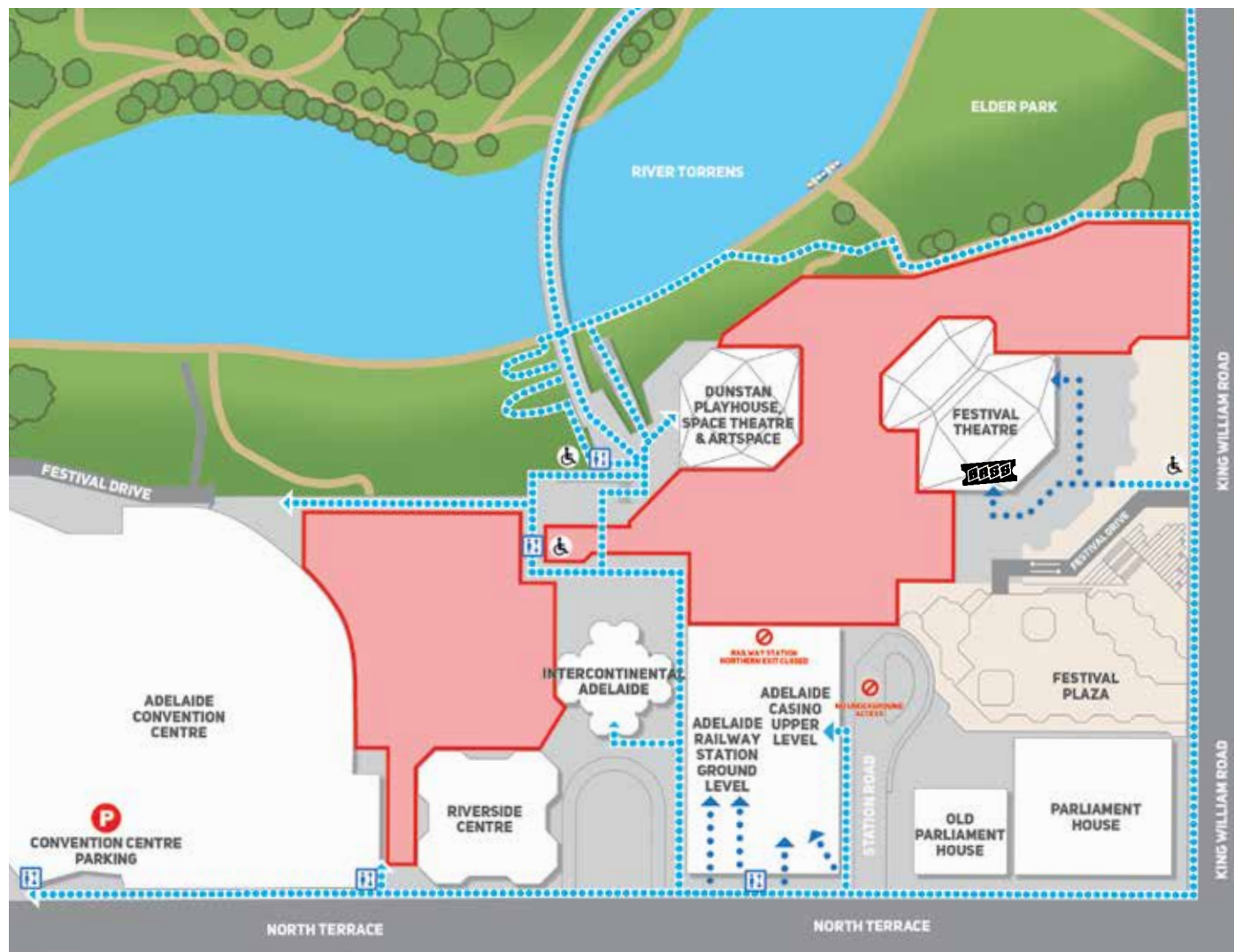

Information correct at time of printing. November 2016

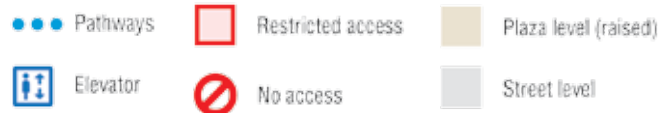

For information about access for patrons with disability, please visit adelaidefestivalcentre.com.au